



WELDONSHANK

AVAILABLE VERSIONS

- HSS
- HSS Co 8 %
- TCT with carbide tips
- TRC with carbide tips (optimised for railway tracks)

The different versions are suitable for aluminium and steel with low tensile strength (HSS), steels with high tensile strength (HSS Co 8%) as well as stainless steels and cast (TCT).

There is a differentiation between the following maximal drilling depths: 30mm, 55mm, 75mm and 100mm.

► **CORE DRILLS**

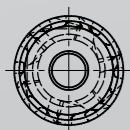

◀ **TWIST DRILL**

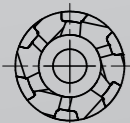

◀ **CORE DRILLS**

Core drills are used in core drilling machines. They are cutting with the edges and do not chip the whole drilling diameter. Thus, the drilling time is reduced and the tool life prolonged. With a drilling diameter of 100mm, a twist drill chips 650 % more material.

Core drills are mounted with guide pins which centre the drill. The core drill has spiral flutes and a special cutting edge geometry. Inner and outer edges are processed reciprocal.

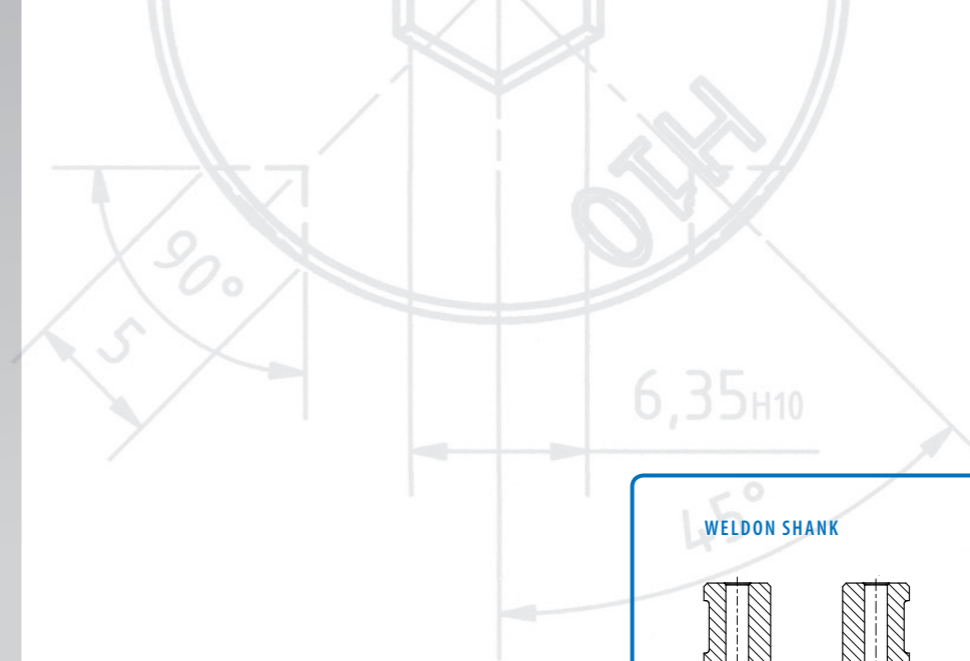

WELDON SHANK

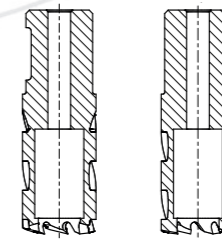

Core drills have a Weldon shank 3/4 inch (19,05mm) up to 60mm drilling depth or 32 mm up to 130mm drilling depth, or a so called "Quickin" shank or a combination of Weldon and "Quickin" shank – the so-called multi shank.

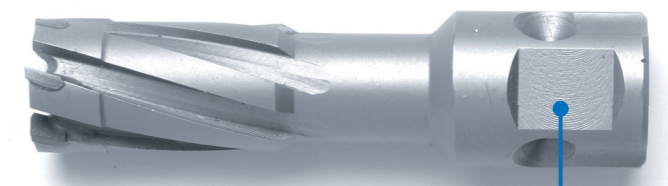

QUICKIN SHANK



CORE DRILLING MACHINE

CORE DRILLS

TECHNICAL INFORMATION



Material HSS

3/4" Weldon shank

Diameter	Art.-No. Cutting depth 30 mm	Art.-No. Cutting depth 55 mm	Art.-No. Cutting depth 75 mm	Art.-No. Cutting depth
12	06010012	06011012	06012012	06013012
13	06010013	06011013	06012013	06013013
14	06010014	06011014	06012014	06013014
15	06010015	06011015	06012015	06013015
16	06010016	06011016	06012016	06013016
17	06010017	06011017	06012017	06013017
18	06010018	06011018	06012018	06013018
19	06010019	06011019	06012019	06013019
20	06010020	06011020	06012020	06013020
21	06010021	06011021	06012021	06013021
22	06010022	06011022	06012022	06013022
23	06010023	06011023	06012023	06013023
24	06010024	06011024	06012024	06013024
25	06010025	06011025	06012025	06013025
26	06010026	06011026	06012026	06013026
27	06010027	06011027	06012027	06013027
28	06010028	06011028	06012028	06013028
29	06010029	06011029	06012029	06013029
30	06010030	06011030	06012030	06013030
31	06010031	06011031	06012031	06013031
32	06010032	06011032	06012032	06013032
33	06010033	06011033	06012033	06013033
34	06010034	06011034	06012034	06013034
35	06010035	06011035	06012035	06013035
36	06010036	06011036	06012036	06013036
37	06010037	06011037	06012037	06013037
38	06010038	06011038	06012038	06013038
39	06010039	06011039	06012039	06013039
40	06010040	06011040	06012040	06013040
41	06010041	06011041	06012041	06013041
42	06010042	06011042	06012042	06013042
43	06010043	06011043	06012043	06013043
44	06010044	06011044	06012044	06013044
45	06010045	06011045	06012045	06013045
46	06010046	06011046	06012046	06013046
47	06010047	06011047	06012047	06013047

Diameter	Art.-No. Cutting depth 30 mm	Art.-No. Cutting depth 55 mm	Art.-No. Cutting depth 75 mm	Art.-No. Cutting depth
48	06010048	06011048	06012048	06013048
49	06010049	06011049	06012049	06013049
50	06010050	06011050	06012050	06013050
51	06010051	06011051	06012051	06013051
52	06010052	06011052	06012052	06013052
53	06010053	06011053	06012053	06013053
54	06010054	06011054	06012054	06013054
55	06010055	06011055	06012055	06013055
56	06010056	06011056	06012056	06013056
57	06010057	06011057	06012057	06013057
58	06010058	06011058	06012058	06013058
59	06010059	06011059	06012059	06013059
60	06010060	06011060	06012060	06013060
61	06010061	06011061	06012061	06013061
62	06010062	06011062	06012062	06013062
63	06010063	06011063	06012063	06013063
64	06010064	06011064	06012064	06013064
65	06010065	06011065	06012065	06013065
66	06010066	06011066	06012066	06013066
67	06010067	06011067	06012067	06013067
68	06010068	06011068	06012068	06013068
69	06010069	06011069	06012069	06013069
70	06010070	06011070	06012070	06013070
71	06010071	06011071	06012071	06013071
72	06010072	06011072	06012072	06013072
73	06010073	06011073	06012073	06013073
74	06010074	06011074	06012074	06013074
75	06010075	06011075	06012075	06013075
76	06010076	06011076	06012076	06013076
77	06010077	06011077	06012077	06013077
78	06010078	06011078	06012078	06013078
79	06010079	06011079	06012079	06013079
80	06010080	06011080	06012080	06013080
81	06010081	06011081	06012081	06013081
82	06010082	06011082	06012082	06013082
83	06010083	06011083	06012083	06013083
84	06010084	06011084	06012084	06013084
85	06010085	06011085	06012085	06013085
86	06010086	06011086	06012086	06013086
87	06010087	06011087	06012087	06013087
88	06010088	06011088	06012088	06013088
89	06010089	06011089	06012089	06013089
90	06010090	06011090	06012090	06013090
91	06010091	06011091	06012091	06013091